

Back plate with sleeve



Backplate with welded sleeve provides safe, waterproof bolt penetration through membranes and polyurethane foam. The sleeve is designed to prevent water from following the bolt through the joint. Threads on Pc Coated sleeves are oversized to secure correct fit for bolt with Pc Coat. Corrosion protection according to requirements in N500 from Statens Vegvesen. Can be delivered in stainless steel, see separate data sheet for details.

Stock programme:

Backplate w/sleeve – watertight M16 Pc-Coat
Backplate w/sleeve – watertight M20 Pc-Coat
Backplate w/sleeve – watertight M24 Pc-Coat
Backplate w/sleeve – watertight M33 Pc-Coat
Backplate w/sleeve – watertight M42 Pc-Coat
Other dimensions on request

Technical information:

Material plate: Steel S235 / Q235:

Threaded rod grade 8.8 acc to ISO 898-1.

Option: Can be supplied in stainless steel (1.4404).

See separate datasheet for details.

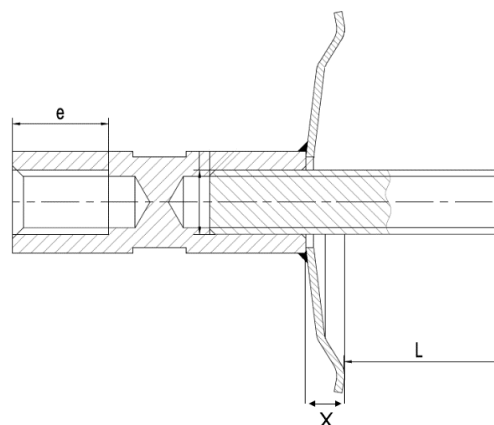

Dimension	Length sleeve (mm)	Thread length e (mm)	Thread rod L (mm)	X +/-1 (mm)	Surface	Weight kg (Ex tread rod)
M16	75	2x25	98	13	PC Coat™	0,6
M20	85	2x30	98	13	PC Coat™	0,8
M24	110	2x36	67	13	PC Coat™	1,0
M33	150	2x50	78	13	PC Coat™	1,7
M42	150	2x50	88	13	PC Coat™	2,3

Corrosion protection/ Pc-Coat™

Hot-dip galvanization is carried out in compliance with NS-EN-ISO 1461 and epoxy powder coating in compliance with NS-EN 13438. With regard to coating thickness and further information, please see Document Q/PTC-T19A – Specification for Pc-Coat – SVV/JBV. Please also refer to the Pc-Coat Product Data Sheet and accompanying FDV documentation.

Accessories:

Rebar bolts, threaded rods, angle washer and nut. Front plate 140x3 mm All in Pc-Coat™.